

LeakTM Buster SmokeMaker

AN AMERICAN SAFETY COMPANY



Operation Manual

©2016 Copyright American Safety & Health Promotions LTD.

General Information

- The LeakBuster™ is NOT waterproof however and has not been rated to operate in such conditions. However the case is equipped with fan guards and a drain plug to allow mitigation of moisture infiltration if this occurs. Always use outlets with GFCI protection when moisture is possible.
- The LeakBuster™ is equipped with a NEMA 5-20P marine power inlet. It is also equipped with (2) 5-20R receptacles inside the case for power hookup to smoke machine and blower unit. Both inlet and receptacle connectors have been chosen to allow support for higher wattage machines.
- Standard 5-15P accessories and machines may also be used with the 5-20R receptacles. A 5-20R to 5-15P adapter is included to convert the inlet to a standard extension cord when less than 15 amps will be used by the machine and blower.

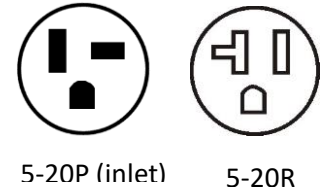

5-20P (inlet)

5-20R



5-30R to 5-15P

General Arrangement

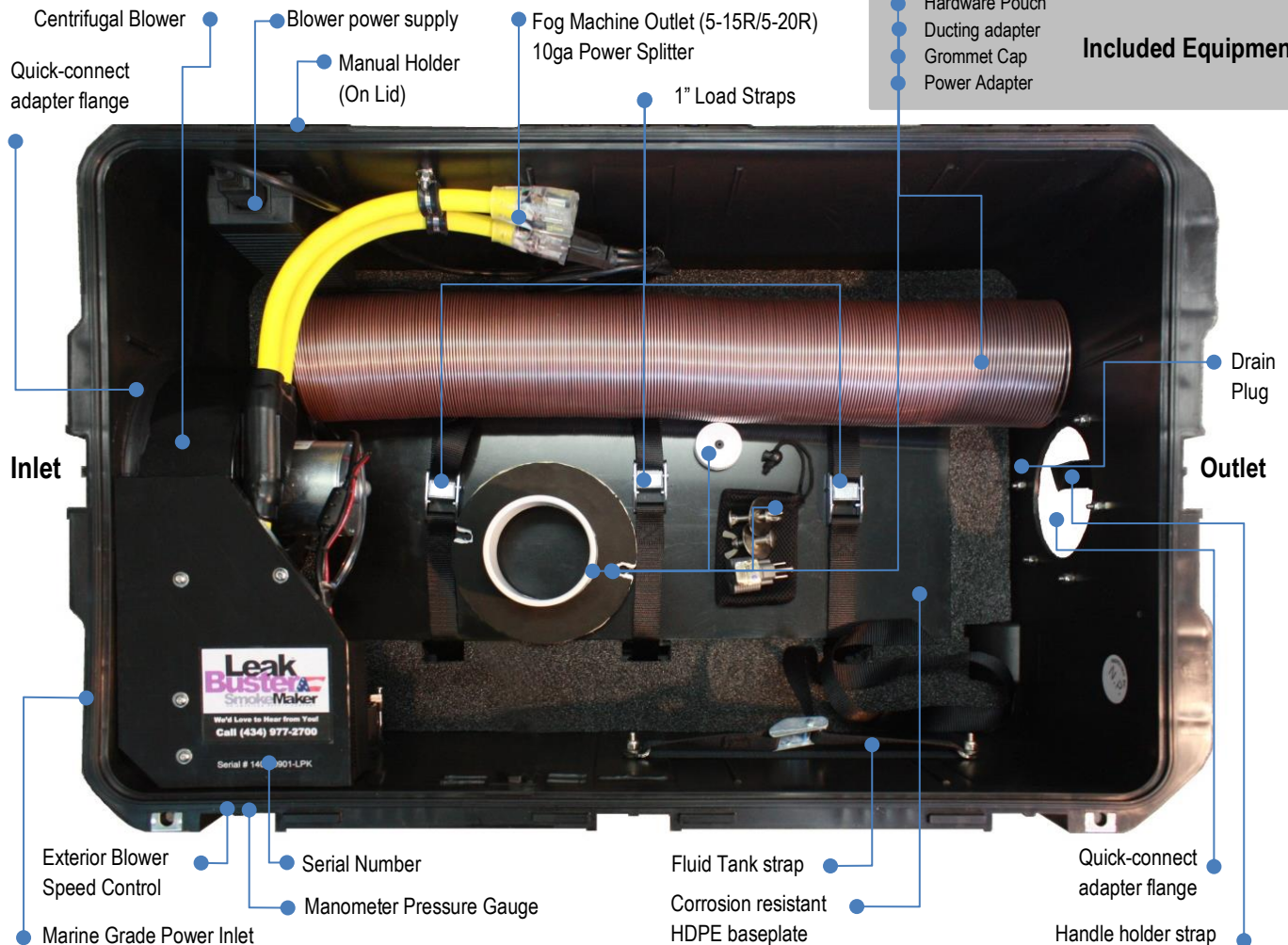

- The LeakBuster™ powered by a centrifugal blower with DC motor control. A motor speed control is located on the exterior of the case so that adjustments can be made without opening the case and disturbing the pressurization.
- The case is also equipped with a professional grade manometer pressure gauge for blower speed fine tuning, applied pressure measurement, and troubleshooting.



- The LeakBuster™ will also accommodate other similar sized machines given they are no greater than 11"W x 12.75"H x 29"L (including cord end)

Setup: When Ducting Pressurized Fog

- Connect power source to LeakBuster™ using a extension cable rated at 20 amps, 125v. Ensure that the is properly protected with Ground fault circuit interruption (GFCI) and any other protections required for operation of equipment in desired locations.
- Connect ducting adapter. Secure 4" flexible PVC hose to adapter. The included quick connect coupler on the end of the hose can be attached readily into a 4" PVC pipe. Other connections are possible with standard pipe fittings

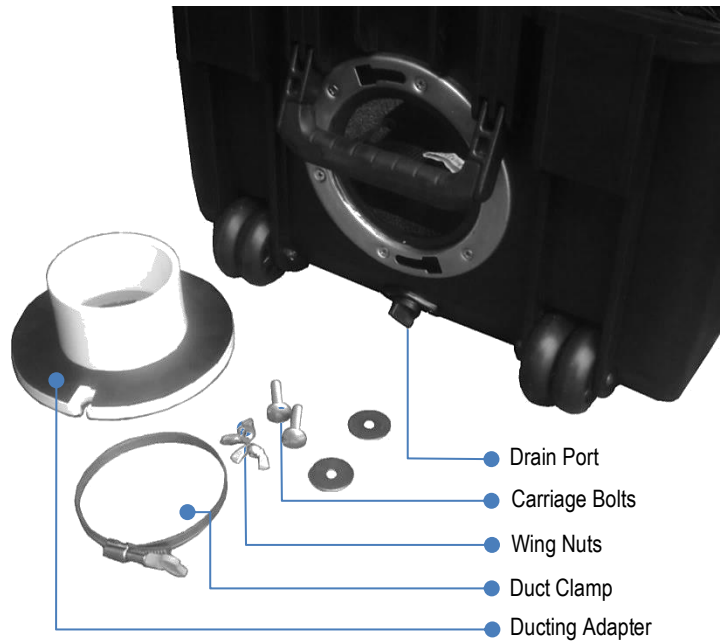

Place Carriage Bolts in Flange



Position Duct Adapter



Secure with Wing Nuts



Tighten clamp around duct

- Ensure fog fluid line is connected and machine has sufficient fluid in the tank. Turn on the fog machine and set to desired setting.
- Close and secure case lid and drain port. In order to develop pressure the case must be sealed.
- Turn on motor and set to the desired power. The Manometer pressure gauge and speed control can be used to fine tune applied pressures and flow rates.

Setup: When Using an Intake Duct

- Use this method for doing leak tests where the leak buster is placed inside the test subject and intake air is brought through a duct
- Connect power source to LeakBuster™ using a grounded extension cable rated at 20 amps, 125v. Ensure that the power source is properly protected with Ground fault circuit interruption (GFCI) and any other protections required for operation of equipment in desired locations.
- Connect ducting adapter. Secure 4" flexible PVC hose to adapter. The included quick connect coupler on the end of the hose can be attached readily into a 4" PVC pipe. Other connections are possible with standard pipe fittings



Place Carriage Bolts in Flange



Position Duct Adapter



Secure with Wing Nuts



Tighten clamp around duct

- Ensure fog fluid line is connected and machine has sufficient fluid in the tank. Turn on the fog machine and set to desired setting.
- Close and secure case lid and drain port. In order to develop pressure the case must be sealed.
- Connect the duct to the intake port for the room. There are many configurations possible to achieve the desired result. A few possible intake ports could be a window, door undercut (with door sweep adapter), or dryer vent. Check SmokeMaker Online for ducting examples and additional accessories.
- Turn on motor and set to the desired power. The Manometer pressure gauge and speed control can be used to fine tune applied pressures and flow rates.



Setup: When using as a weather resistant enclosure
(Not Ducted)

- Connect power source to LeakBuster™ using a grounded extension cable rated at 20 amps, 125v. Ensure that the power source is properly protected with Ground fault circuit interruption (GFCI) and any other protections required for operation of equipment in desired locations.
- When ducting is not required, use the included handle strap to secure the handle from obstructing the fog output.
- Open the drain plug near the transport wheels to allow collected water or fog fluid to drain. If you are not ducting, the drain can be open during operation. The drain plug should be clear of any water and the case given a level or slight inclination towards the drain plug to allow gravity to empty the case. Dispose of fog fluids properly according to specific directions from manufacturer.

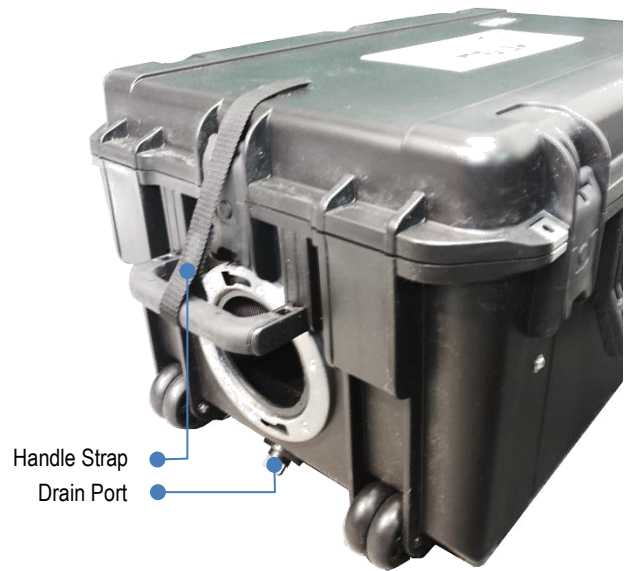

PRECAUTIONS! WARNING!

For life safety and protection of equipment please respect the following:

- Do not Transport a fog machine inside the case without securing the machine tightly using the (3) included load straps.
- Do not ship machines inside cases with any method that cannot ensure that cases remain right side up during transport. Serious damage may occur to the machine and case if it is inadvertently placed upside down and subjected to typical transport loads in this orientation. The case has not been designed for this loading which is far greater than that subjected to a case in its proper orientation.
- If shipping a machine inside the case, place packing material around and above the machine. This will reduce the risk of damage to both the machines and case. Damage to cases and machines in shipping is not covered by the warranty.
- Be sure that all machine tanks are empty when transporting to prevent spilling inside the case.
- Use care when considering power connections and current draw.
- Do not operate the case when it is submerged in water.
- Do not carry the case with the longer side handle when fog machine is installed. Instead use both of the shorter side handles if the loaded case needs to be carried. The pull out handle can be used when the machine is secured by load straps.



Warranty

The LeakBuster™ comes with a standard one-year warranty on parts and service.

Contact

Please contact ASHP for Sales or Service

- **Phone:**

1-888-BUY-ASHP
(1-888-289-2747) Toll-free
(434) 977-2700
(434) 977-0111 Fax

- **Email:**

cfo@americansafetyandsmoke.com

- **Mailing and Shipping Address**

513 Stewart St, Suite G
Charlottesville VA 22902-5473

 **American Safety™
& Smoke Maker**
Helping you serve your community better

MADE IN

U. S. A.